

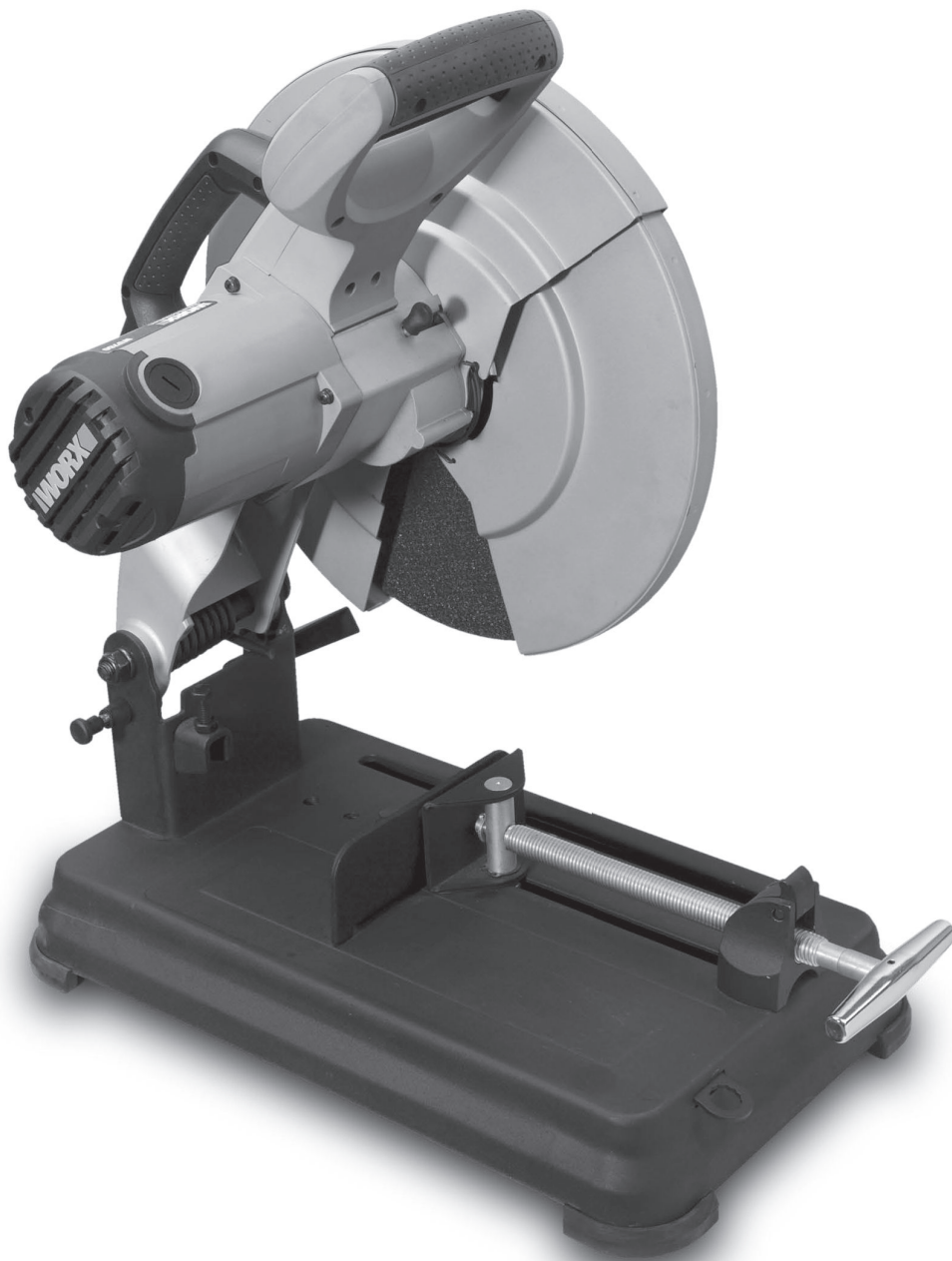

WORX



SAFETY AND OPERATING MANUAL

Cut off saw

WX760.1

SAFETY INSTRUCTIONS

 **WARNING!** When using electric tools basic safety precautions should always be followed to reduce the risk of fire, electric shock and personal injury including the following.

Read all these instructions before attempting to operate this product and save these instructions.

1. Keep work area clear
 - Cluttered areas and benches invite injuries.
2. Consider work area environment
 - Do not expose tools to rain.
 - Do not use tools in damp or wet locations.
 - Keep work area well lit.
 - Do not use tools in the presence of flammable liquids or gases.
3. Guard against electric shock
 - Avoid body contact with earthed or grounded surfaces (e.g. pipes, radiators, ranges, refrigerators).
4. Keep other persons away
 - Do not let persons, especially children, not involved in the work touch the tool or the extension cord and keep them away from the work area.
5. Store idle tools
 - When not in use, tools should be stored in a dry locked-up place, out of reach of children.
6. Do not force the tool
 - It will do the job better and safer at the rate for which it was intended.
7. Use the right tool
 - Do not force small tools to do the job of a heavy duty tool.
 - Do not use tools for purposes not intended; for example do not use circular saws to cut tree limbs or logs.
8. Dress properly
 - Do not wear loose clothing or jewellery, they can be caught in moving parts.
 - Non-skid footwear is recommended when working outdoors.
 - Wear protective hair covering to contain long hair.
9. Use protective equipment
 - Use safety glasses.
 - Use face or dust mask if working operations create dust.
10. Connect dust extraction equipment
 - If the tool is provided for the connection of dust extraction and collecting equipment, ensure these are connected and properly used.
11. Do not abuse the cord
 - Never yank the cord to disconnect it from the socket. Keep the cord away from heat, oil and sharp edges.
12. Secure work
 - Where possible use damps or a vice to hold the work. It is safer than using your hand.
13. Do not overreach
 - Keep proper footing and balance at all times.
14. Maintain tools with care
 - Keep cutting tools sharp and clean for better and safer performance.
 - Follow instruction for lubricating and changing accessories.
 - Inspect tool cords periodically and if damaged have them repaired by an authorized service facility.
 - Inspect extension cords periodically and replace if damaged.
 - Keep handles dry, clean and free from oil and grease.
15. Disconnect tools
 - When not in use, before servicing and when changing accessories such as blades, bits and cutters, disconnect tools from the power supply.
16. Remove adjusting keys and wrenches
 - Form the habit of checking to see that keys and adjusting wrenches are removed from the tool before turning it on.
17. Avoid unintentional starting
 - Ensure switch is in "off" position when plugging in
18. Use outdoor extension leads
 - When the tool is used outdoors, use only extension cords intended for outdoor use and so marked.

19. Stay alert
 - Watch what you are doing, use common sense and do not operate the tool when you are tired.
 20. Check damaged parts
 - Before further use of tool, it should be carefully checked to determine that it will operate properly and perform its intended function.
 - Check for alignment of moving parts, binding of moving parts, breakage of parts, mounting and any other conditions that may affect its operation.
 - A guard or other part that is damaged should be properly repaired or replaced by an authorized service centre unless otherwise indicated in this instruction manual.
 - Have defective switches replaced by an authorized service centre.
 - Do not use the tool if the switch does not turn it on and off.
 21. **WARNING**
 - The use of any accessory or attachment other than one recommended in this instruction manual may present a risk of personal injury.
 22. Have your tool repaired by a qualified person
 - This electric tool complies with the relevant safety rules. Repairs should only be carried out by qualified persons using original spare parts, otherwise this may result in considerable danger to the user.
3. For example: Some types of dust are considered to be carcinogenic. Use suitable dust vacuuming and wear a dust protection mask.
 4. Light metal dust can burn or explode. Always keep the workplace clean since mixed materials are especially dangerous.
 5. Wear protective gloves and sturdy shoes. When necessary, also wear protective clothing.
 6. Connect machines that are used outdoors by means of a fault current circuit breaker (FI) with a maximum triggering current of 30 mA. Use only an extension cable that is approved for outdoor use.
 7. Always lead the cable to the rear away from the machine.
 8. Use the machine only for dry cutting.
 9. Take hold of the electric tool only by the insulated handle when the cutting tool could come in contact with hidden wiring or its own power cable. Contact with voltage carrying wiring can place the metal parts of the machine also under voltage and lead to an electrical shock.
 10. Never stand on the machine. Serious injury could occur if the tool is tipped or if the cutting tool is accidentally started.
 11. Use cutting discs whose allowable speed is at least as high as the no load speed of the machine. Check the cutting disc before use.
 12. Keep your body positioned to either side of but not in line with the cutting disc. In case of a burst disc, your body is better protected from possible fragments.
 13. The cutting disc must be flawlessly mounted and be able to rotate freely. Make a test run of at least one minute without load. Do not use damaged, out of round or vibrating cutting discs. Always correctly adjust the depth stop. When the depth stop is not properly adjusted, the cutting disc can cut into the surface underneath the base plate.
 14. During operation, the cutting disc cover must be attached and the protective pendulum hood must be functioning properly.
 15. Do not work with magnesium or materials

SPECIFIC SAFETY RULES FOR CUT OFF SAWS

1. If the power cable is damaged or cut through while working, do not touch the cable, and pull the power plug out immediately. Never use the machine with a damaged cable.
2. Wear protective glasses and hearing protection. Dust is generated while working that can be detrimental to health, inflammable or explosive. Suitable protective measure are required.

- containing asbestos.
16. Protect the cutting disc from impacts, shocks and grease.
 17. Apply the machine to the work piece only when it is switched on.
 18. Keep your hands away from the rotating cutting disc.
 19. When cutting metal, sparks are generated. Take care that no persons are endangered. Because of the danger of fire, no combustible materials should be located in the vicinity (spark flying zone).
 20. Blocking of the cutting disc leads to a jerking reaction of the machine. In this case, switch off the machine immediately.
 21. Do not ram the cutting disc with force into the work piece or apply too much pressure when using the machine. Avoid especially the catching of the cutting disc when working on corners, sharp edges, etc. When the cutting disc is damaged due to misuse, it may develop cracks that could lead to bursting without warning.
 22. Avoid overloading the motor especially when working with large work pieces. When cutting, apply only light pressure to the handle.
 23. Observe the dimensions of the cutting disc. The hole diameter must fit on the tool spindle or the adapter without play.
 24. Do not apply sideways pressure to the cutting disc.
 25. Observe the instructions of the manufacturer for the mounting and usage of the cutting disc.
 26. Caution! The cutting disc continues to run after the machine is switched off.
 27. Actuate the spindle locking only when the cutting disc is at a standstill.
 28. The cutting disc becomes very hot while working; never take hold of it before it has cooled.
 29. Do not use the cutting-off grinders without guards in position.
 30. Read the operating instructions supplied by the wheel manufacturer.

SYMBOLS



Read the manual



Warning



Double insulation



Wear eye protection



Wear ear protection



Wear dust mask



Rcm approval mark

5112

A

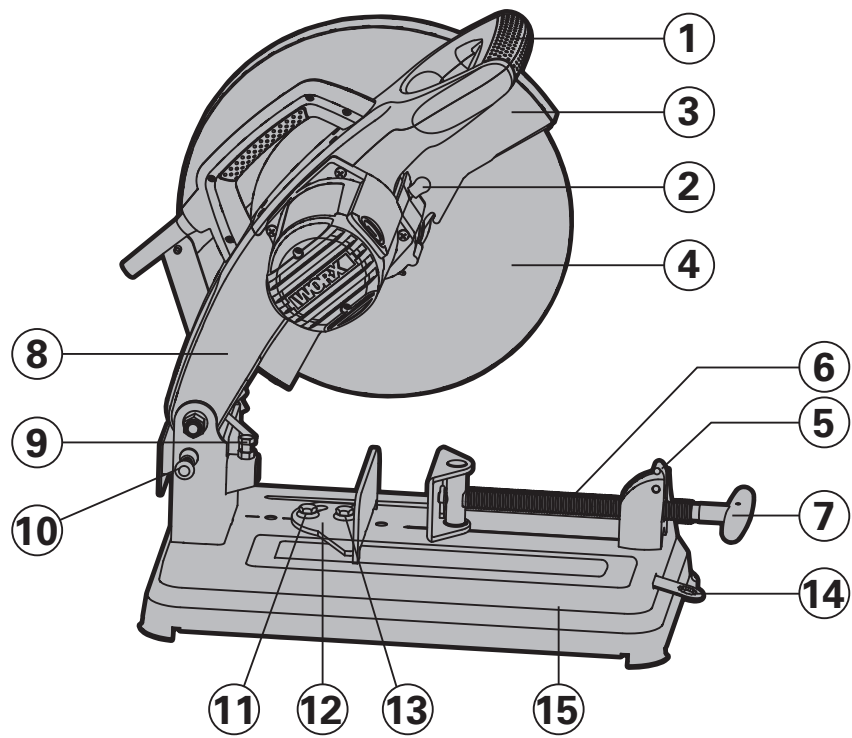

B

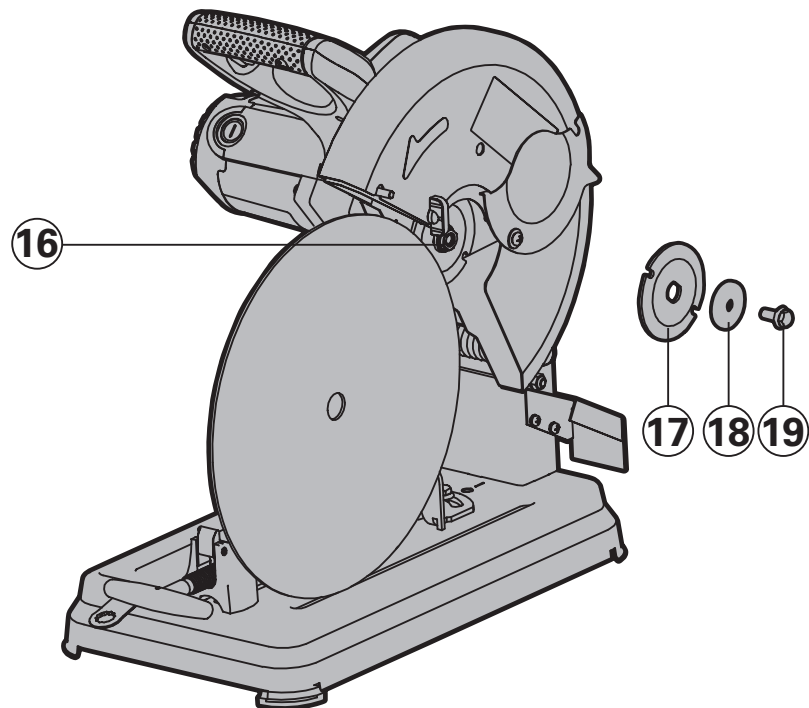

Cut off saw

WX760.1

-
- 1. HANDLE**

 - 2. SPINDLE LOCK**

 - 3. PENDULUM PROTECTIVE HOOD**

 - 4. CUTTING DISC**

 - 5. LOCKING LEVER**

 - 6. CLAMPING SPINDLE**

 - 7. CLAMPING SPINDLE HANDLE**

 - 8. TOOL ARM**

 - 9. LOCKING NUT FOR DEPTH STOP**

 - 10. LOCK PIN**

 - 11. FENCE BOLT A**

 - 12. ANGLE STOP**

 - 13. FENCE BOLT B**

 - 14. SPANNER**

 - 15. BASE PLATE**

 - 16. TOOL SPINDLE**

 - 17. CLAMPING FLANGE**

 - 18. WASHER**

 - 19. HEX HEAD BOLT**

 - 20. ON/OFF SWITCH (See Fig.D)**

 - 21. SWITCH LOCK (See Fig.D)**
-

Not all the accessories illustrated or described are included in standard delivery.

TECHNICAL DATA

Rated voltage:	220-240 V~50/60 Hz
Rated Power:	2300 W
Rated no Load Speed:	3500 /min
Disc size:	355 mm
Disc bore:	25.4 mm
Disc thickness	3mm
Double insulation:	<input type="checkbox"/>
Machine weight:	18.5 kg

NOISE AND VIBRATION DATA

A weighted sound pressure	99 dB(A)
A weighted sound power	112 dB(A)
Wear ear protection when sound pressure is over	85dB(A) 
Typical weighted vibration	3.7 m/s ²

ACCESSORIES

Use discs with the following specification: 355mm diameter, 25.4mm bore

Spanner

1pc

Disc (on machine)

1pc

We recommend that you purchase your accessories from the same store that sold you the tool. Use good quality accessories marked with a well-known brand name. Choose the type according to the work you intend to undertake. Refer to the accessory packaging for further details. Store personnel can assist you and offer advice.

Cut off saw

WX760.1

OPERATING INSTRUCTIONS



NOTE: Before using the tool, read the instruction book carefully.

BEFORE USE

To ensure safe handling, the feet of the base plate (15) must be placed on a suitable platform (e.g. workbench, even floor, etc.).

1. LOCK PIN

Remove the plug from the socket before carrying out any adjustment, servicing or maintenance.

The Lock pin (10) makes easier handling of the machine when transporting to the various working locations.

Securing the machine (Transport position)

Swing the tool arm (8) with the operating handle (1) downward till it stops. Press in the lock pin (10) and release the handle.

Releasing the machine (Working position)

Press the tool arm with the operating handle of the machine downward to relieve the load on the lock pin. Pull the lock pin outward and guide the tool arm slowly upward.

Please make sure that the lock pin is not pressed in, otherwise the tool arm cannot be swung down to the desired depth.

2. CHANGING THE CUTTING DISC (See Fig. B)

Remove the plug from the socket before carrying out any adjustment, servicing or maintenance.

Use only cutting discs that correspond to the characteristic data given in these operating instructions.

Use only cutting discs whose allowable speed is as high as the no load speed of the machine.

Actuate the spindle lock only when the cutting disc is at a standstill.

Removing the cutting disc

Place the machine in the working position.

Swing the pendulum protection hood (3) upwards to the stop.

Turn the hex head bolt (19) anticlockwise with the spanner (14) provided while pressing the spindle lock

at the same time until it engages.
Keeping the spindle lock depressed then unscrew the hex head bolt. Remove the washer (18) and the clamping flange (17).
Remove the cutting disc.

Installing the cutting disc

If necessary, clean all parts to be mounted.
Place the new cutting disc on the tool spindle (16) so that the label points away from the tool arm.
Place on the clamping flange, the washer and screw in the hex head bolt.
Press the spindle lock until it engages and tighten the hex head bolt clockwise.
Guide the pendulum protection hood back down.

3. ADJUSTING THE MITRE ANGLE

The mitre angle can be set in a range from 0° to 45°. Often used angles are identified on the angle stop (12) with appropriate marking. The 0° and 45° positions are set at the end stops.
Loosen the two fence bolts (11 & 13) with the spanner provided. Set the desired angle and retighten the fence bolts.

4. CLAMPING THE WORK PIECE (SEE FIG. C)

To ensure optimum work safety, the work piece must always be firmly clamped.
Place the work piece against the fence of the angle stop. Slide the clamping spindle against the work piece and clamp the work piece firmly with the aid of the spindle handle.

Releasing the Work Piece

Loosen the spindle handle. Release the locking lever and pull the clamping spindle away from the work piece.

5. OPERATING THE MACHINE

Switching on and off (See Fig. D)

To **switch on**, slide the button (21) to the left. Then press the on/off switch (20) and hold it depressed .

For safety reasons, the on/off switch of the machine cannot be locked on but must remain depressed during operation.

To **switch off** the machine, release the on/off switch.

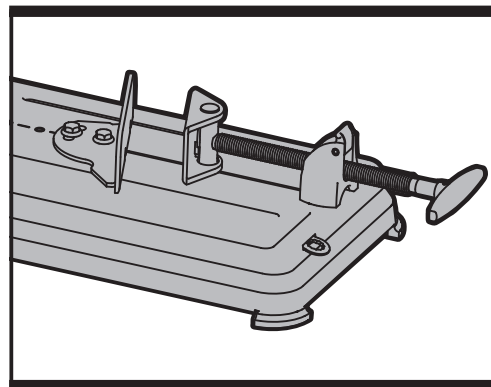

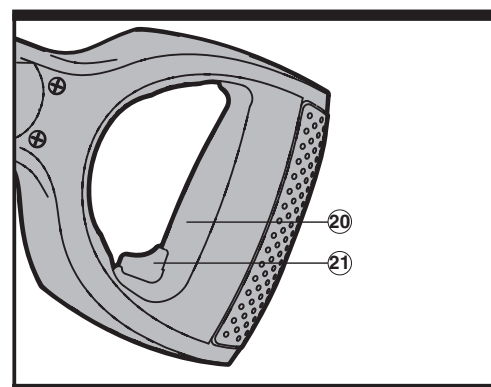

C



D

WORKING INSTRUCTIONS

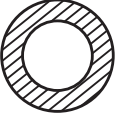
Maximum work piece dimensions [mm]

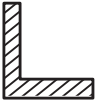
Work piece-form	Mitre angle	
	0°	45°
	120 outer Dia.	110 outer Dia.
	110 x 110	96 x 96
	80 x 210	70 x 120
	135 x 135	88 x 88

Do not load the machine so heavily that the disc comes to a stand still.

Advancing too fast considerably reduces the performance capabilities of the machine and shortens the service life of the cutting disc.

The cutting disc becomes very hot while working; do not take hold of it until it has cooled.

Use only cutting discs that are suitable for the material to be worked.

DEPTH STOP

As delivered, the depth stop is set so that a new 355mm cutting disc does not touch the base plate when sawing. To compensate for the wear of the cutting disc, the depth stop can be set deeper.

With the use of a new cutting disc, the depth stop must always be set back to the original position.

Always adjust the depth stop so that the cutting disc does not touch the base plate when sawing.

Adjusting the depth stop

Remove the plug from the socket before carrying out any adjustment, servicing or maintenance.

Loosen the locking nut (9) with the wrench provided. Set the tool arm (8) with the spanner to the desired position.

Screw the depth stop in the clockwise or counter clockwise direction until the bolt head rests on the housing.

Guide the tool arm slowly upward and tighten the locking nut.

MAINTENANCE

Remove the plug from the socket before carrying out any adjustment, servicing or maintenance.

Your power tool requires no additional lubrication or maintenance.

There are no user serviceable parts in your power tool. Never use water or chemical cleaners to clean your power tool. Wipe clean with a dry cloth. Always store your power tool in a dry place. Keep the motor ventilation slots clean. Keep all working controls free of dust. Occasionally you may see sparks through the ventilation slots. This is normal and will not damage your power tool.

If the supply cord is damaged, it must be replaced by the manufacturer, its service agent or similarly qualified persons in order to avoid a hazard.

WORX
you've got the power

Copyright © 2008, Positec. All Rights Reserved.