



WORX



SAFETY AND OPERATING MANUAL

Reciprocating saw

WX401

SAFETY INSTRUCTIONS



WARNING! Read all safety warnings and all instructions. Failure to follow the warnings and instructions may result in electric shock, fire and/or serious injury.

Save all warnings and instructions for future reference.

The term “power tool” in the warnings refers to your mains-operated (corded) power tool or battery-operated (cordless) power tool.

1) WORK AREA SAFETY

- a) **Keep work area clean and well lit.**
Cluttered or dark areas invite accidents.
- b) **Do not operate power tools in explosive atmospheres, such as in the presence of flammable liquids, gases or dust.** Power tools create sparks which may ignite the dust or fumes.
- c) **Keep children and bystanders away while operating a power tool.**
Distractions can cause you to lose control.

2) ELECTRICAL SAFETY

- a) **Power tool plugs must match the outlet. Never modify the plug in any way. Do not use any adapter plugs with earthed (grounded) power tools.**
Unmodified plugs and matching outlets will reduce risk of electric shock.
- b) **Avoid body contact with earthed or grounded surfaces such as pipes, radiators, ranges and refrigerators.**
There is an increased risk of electric shock if your body is earthed or grounded.
- c) **Do not expose power tools to rain or wet conditions.** Water entering a power tool will increase the risk of electric shock.
- d) **Do not abuse the cord. Never use the cord for carrying, pulling or unplugging the power tool. Keep cord away from heat, oil, sharp edges or moving parts.** Damaged or entangled cords increase the risk of electric shock.
- e) **When operating a power tool outdoors, use an extension cord suitable for outdoor use.** Use of a cord suitable for outdoor use reduces the risk of electric shock.

- f) **Recommendation for the use of a residual current device with a rated residual current of 30 mA or less.**

3) PERSONAL SAFETY

- a) **Stay alert, watch what you are doing and use common sense when operating a power tool. Do not use a power tool while you are tired or under the influence of drugs, alcohol or medication.** A moment of inattention while operating power tools may result in serious personal injury.
 - b) **Use personal protective equipment. Always wear eye protection.** Protective equipment such as dust mask, non-skid safety shoes, hard hat, or hearing protection used for appropriate conditions will reduce personal injuries.
 - c) **Prevent unintentional starting. Ensure the switch is in the off-position before connecting to power source and/or battery pack, picking up or carrying the tool.** Carrying power tools with your finger on the switch or energising power tools that have the switch on invites accidents.
 - d) **Remove any adjusting key or wrench before turning the power tool on.** A wrench or a key left attached to a rotating part of the power tool may result in personal injury.
 - e) **Do not overreach. Keep proper footing and balance at all times.** This enables better control of the power tool in unexpected situations.
 - f) **Dress properly. Do not wear loose clothing or jewellery. Keep your hair, clothing and gloves away from moving parts.** Loose clothes, jewellery or long hair can be caught in moving parts.
 - g) **If devices are provided for the connection of dust extraction and collection facilities, ensure these are connected and properly used.** Use of these devices can reduce dust-related hazards.
- ## 4) POWER TOOL USE AND CARE
- a) **Do not force the power tool. Use**

the correct power tool for your application. The correct power tool will do the job better and safer at the rate for which it was designed.

- b) Do not use the power tool if the switch does not turn it on and off.** Any power tool that cannot be controlled with the switch is dangerous and must be repaired.
- c) Disconnect the plug from the power source and/or the battery pack from the power tool before making any adjustments, changing accessories, or storing power tools.** Such preventive safety measures reduce the risk of starting the power tool accidentally.
- d) Store idle power tools out of the reach of children and do not allow persons unfamiliar with the power tool or these instructions to operate the power tool.** Power tools are dangerous in the hands of untrained users.
- e) Maintain power tools. Check for misalignment or binding of moving parts, breakage of parts and any other condition that may affect the power tools operation. If damaged, have the power tool repaired before use.** Many accidents are caused by poorly maintained power tools.
- f) Keep cutting tools sharp and clean.** Properly maintained cutting tools with sharp cutting edges are less likely to bind and are easier to control.
- g) Use the power tool, accessories and tool bits etc. in accordance with these instructions and in the manner intended for the particular type of power tool, taking into account the working conditions and the work to be performed.** Use of the power tool for operations different from those intended could result in a hazardous situation.

5) BATTERY TOOL USE AND CARE

- a) Ensure the switch is in the off position before inserting battery pack.** Inserting the battery pack into power tools that have the switch on invites accidents.
- b) Recharge only with the charger**

specified by the manufacturer. A charger that is suitable for one type of battery pack.

- c) Use power tools only with specifically designated battery packs.** Use of any other battery packs may create a risk of injury and fire.
- d) When battery pack is not in use, keep it away from other metal objects like paper clips, coins, keys, nails, screw, or other small metal objects that can make a connection from one terminal to another.** Shorting the battery terminals together may cause burns or fire.
- e) Under abusive conditions, liquid may be ejected from the battery; avoid contact, if contact accidentally occurs, flush with water. If liquid contacts eyes, additionally seek medical help.** Liquid ejected from the battery may cause irritation or burns.

6) SERVICE

- a) Have your power tool serviced by a qualified repair person using only identical replacement parts.** This will ensure that that safety of the power tool is maintained.

ADDITIONAL SAFETY RULES FOR YOUR RECIPROCATING SAW

1. Remove the plug from the socket before carrying out any adjustment, servicing or maintenance.
2. Fully unwind cable drum extensions to avoid potential overheating.
3. When an extension cable is required you must ensure it has the correct ampere rating for your power tool and is in a safe electrical condition.
4. Ensure your mains supply voltage is the same as indicated on the rating plate.
5. Your tool is double insulated for additional protection against a possible electrical insulation failure within the tool.
6. Always check walls, floors and ceilings to avoid hidden power cables and pipes.
7. After long working period, external metal

parts and accessories could be hot.

8. Always hold the saw firmly with both hands when operating.
9. Only withdraw the blade from the cut when the blade has been stopped moving.
10. The pivoting blade foot must be held firmly against the material being cut to reduce saw vibration, blade jumping and blade breakage.
11. Before cutting, check the cutting line is free of nails, screws, etc.
12. If possible, ensure the work-piece is firmly clamped to prevent movement.

13. Always wear safety glasses or eye shields when using the reciprocating saw. Everyday eyeglasses have only impact-resistant lenses; they are NOT safety glasses. Following this rule will reduce the risk of serious personal injury.

14. Always wear a face mask or dust mask. Following this rule will reduce the risk of serious personal injury.

15. Always wear hearing protection during extended periods of operation. Following this rule will reduce the risk of serious personal injury.

16. Hold tool by insulated gripping surfaces when performing an operation where the cutting tool may contact hidden wiring or its own cord. Contact with a "live" wire will make the exposed metal parts of the tool "live" and shock the operator.

17. Keep your hands away from cutting area. DO NOT reach under the material being cut because the nearness of the blade to your hand is hidden from your sight.

18. Do not use dull or damaged blades. Bent blades can break easily, or cause kickback.



WARNING: Some dust particles created by power sanding, sawing, grinding, drill and other construction jobs contain chemicals known to cause cancer, birth defects or other reproductive harm. Some examples of these chemicals are:

- Lead from lead-based paints.
- Crystalline silica from bricks and cement and other masonry products.
- Arsenic and chromium from chemically

treated lumber.

Your risk from these exposures varies, depending upon how often you do this type of work. To reduce your exposure to these chemicals:

- Work in a well-ventilated area.
- Work with approved safety equipment, such as those dust masks that are specially designed to filter microscopic particles.

SYMBOLS



To reduce the risk of injury, user must read instruction manual



Double insulation



Warning



Wear ear protection



Wear eye protection



Wear dust mask



RCM approval mark

5112

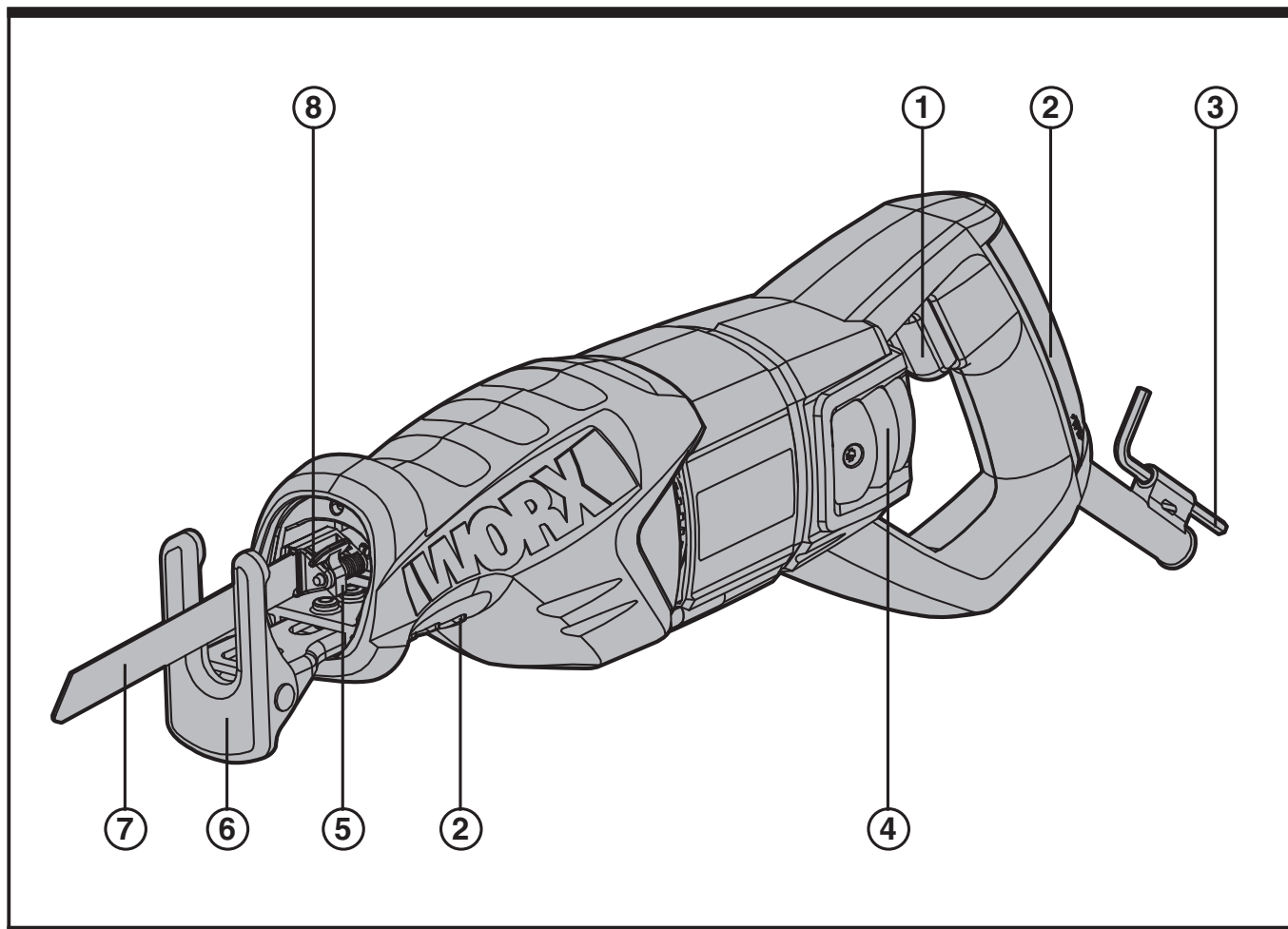

1. TRIGGER SWITCH

2. HAND GRIP AREAS

3. HEX KEY

4. CARBON BRUSHES

5. TOOL-FREE BLADE CLAMP LEVER

6. PIVOTING BLADE FOOT

7. SAW BLADE *

8. TOOL-FREE BLADE HOLDER

*** Not all the accessories illustrated or described are included in standard delivery.**

Reciprocating saw

WX40 I

TECHNICAL DATA

Rated voltage	220-240V~50/60Hz	
Rated power	900 W	
No load speed	0-2600/min	
Max. Cutting capacity	wood	280 mm
	pipe	150 mm
	steel	13 mm
Stroke length	28 mm	
Protection class	 /II	
Weight	3.4 kg	

NOISE / VIBRATION INFORMATION

A weighted sound pressure	86.4dB (A)
A weighted sound power	97.4dB (A)
K_{pA} & K_{wA}	3.0dB (A)
Wear ear protection when sound pressure is over	85dB (A) 
Cutting into wood	5.98m/s ² K=1.5m/s ²
Cutting into metal	10.71m/s ² K=1.5m/s ²

ACCESSORIES

Blades (1pc for metal; 1pc for wood; 1pc for aluminium)

3pcs

We recommend that you purchase your accessories from the same store that sold you the tool. Use good quality accessories marked with a well-known brand name. Choose the type according to the work you intend to undertake. Refer to the accessory packaging for further details. Store personnel can assist you and offer advice.

OPERATING INSTRUCTIONS



NOTE: Before using the tool, read the instruction book carefully.

INTENDED USE:

The machine is intended for sawing wood, plastic, metal and building materials while resting firmly on the workpiece. It is suitable for straight and curved cuts.

ASSEMBLY

REPLACING/INSERTING THE SAW BLADE (See Fig. A)

Remove the plug from the socket before carrying out any adjustment, servicing or maintenance.

When mounting the saw blade, wear protective gloves. Danger of injury when touching the saw blade. When changing the saw blade, take care that the saw blade holder is free of material residue, e. g. wood or metal shavings.

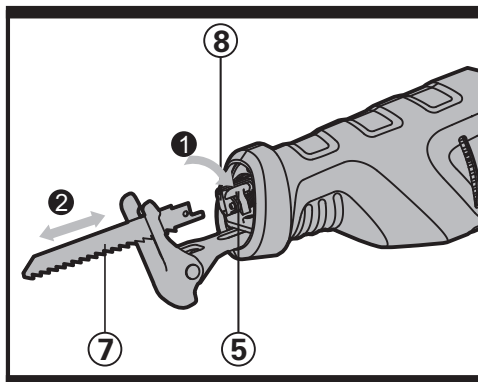

A

1. SELECTING A SAW BLADE

Use only saw blades with single-nose shank. The saw blade should not be longer than required for the intended cut. Use a thin saw blade for narrow curve cuts.

2. INSERTING A SAW BLADE

Rotate the tool-free blade clamp lever (5) in clockwise direction and hold. Fully insert the saw blade (7) into the blade holder (8). Release the clamp lever (5) to lock the blade (7) in position.



Check the tight seating of the saw blade. A loose saw blade can fall out and lead to injuries. For certain work, the saw blade (7) can also be turned through 180° (with the teeth pointed upwards) and reinserted again.

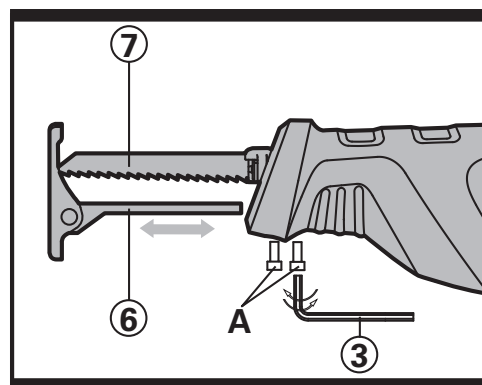

B

3. REMOVING A SAW BLADE

Rotate the tool-free blade clamp lever (5) in clockwise direction and hold. Pull the blade (7) out of the blade holder (8) and release the clamp lever (5).

OPERATION

1. PIVOTING BLADE FOOT (See Fig. B)

It must be held firmly against the material being cut to reduce saw vibration, blade jumping and blade

breakage.

If you need to reduce the cutting capacity of your tool (depth of cut), the pivoting foot plate (6) may be adjusted as follows. Loosen the two securing screws (A) on the underside of the front housing with the spanner (3) provided. Slide the pivoting blade foot (6) to the required position. Tighten both screws (A) and check that the blade foot (6) is firmly latched.

2. SWITCHING ON AND OFF

To start the machine, press the trigger switch (1) and keep it depressed.

To switch off the machine, release the trigger switch (1).

3. CONTROLLING THE STROKE RATE

Increasing or reducing the pressure on the trigger switch (1) enables stepless stroke-rate control of the switched-on machine.

The required stroke rate is dependent on the material and the working conditions and can be determined by a practical trial.

Reducing the stroke rate is recommended when the saw blade engages in the material as well as when sawing plastic and aluminium.

4. CUTTING INSTRUCTION

PLUNGE CUTTING (See Fig. C, D)

 **The plunge cutting procedure is only suitable for treating soft materials such as wood, plaster board or similar! Do not work metal materials with the plunge cutting procedure!**

Use only short saw blades for plunge cutting. Place the machine with the edge of the blade foot (6) onto the workpiece and switch on. For power tools with stroke speed control, set the maximum stroke speed. Press the power tool firmly against the workpiece and allow the saw blade to slowly plunge into the workpiece.

As soon as the blade foot (6) fully lays on the surface of the workpiece, continue sawing alongside the desired cutting line. For certain work, the saw blade (7) can also be inserted turned through by 180° and the sabre saw can be guided accordingly in a reversed manner.

5. FLUSH CUTTING (See Fig. E, F)

 **Pay attention that the saw blade always extends beyond the diameter of the material being worked.** There is danger of kickback. It is possible to make cuts extremely close to floors,

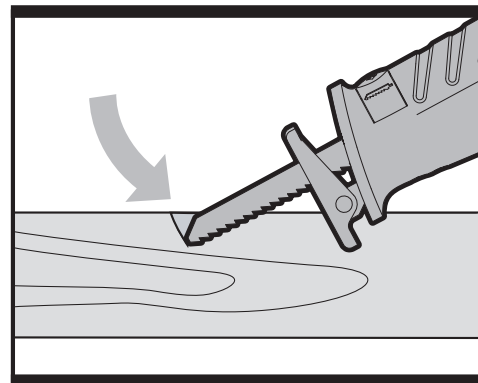

C

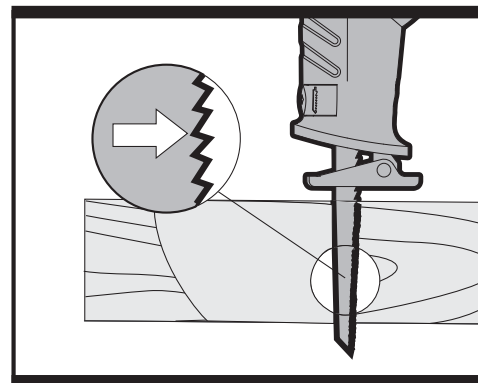

D

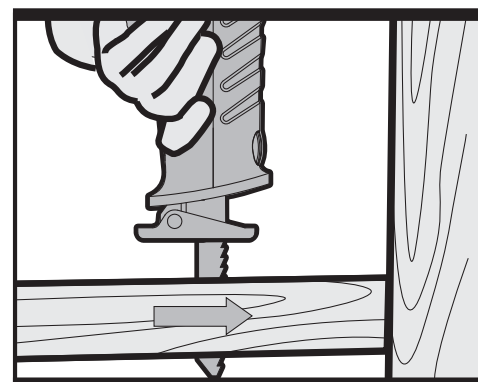

E

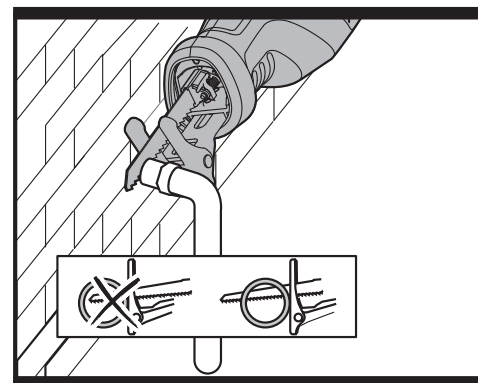

F

walls and other difficult areas. Insert the blade shank into the blade clamp with the blade teeth facing up (opposite to normal working position). This will make cuts closer to the work surface (See Fig E). Using special flexible blades insert the blade into the blade clamp with the blade teeth facing down (normal working position). It will allow flush pipe cutting (See Fig F). Position the saw blade directly against the wall and apply some lateral pressure via the tool until the blade foot faces against the wall. Switch the power tool on and saw through the workpiece, applying constant lateral pressure.

Wood cutting

For easier control use low speed to start cutting, then increase to the correct speed.

Metal cutting

This saw has different metal cutting capacities depending upon the type of blade being used and metal being cut.

Use a finer blade for ferrous metals and a coarse blade for non-ferrous metals.

When cutting thin gauge sheet metals, **ALWAYS** clamp wood on both sides of the sheet. This will give you a clean cut without excess vibration or tearing of the metal.

DO NOT force the cutting blade. Forcing the blade will reduce blade life and cause the blade to break.

WORK HINTS FOR YOUR RECIPROCATING SAW

If your power tool becomes too hot, set the speed to maximum and run a no load for 2-3 minutes to cool the motor.

Always ensure the work-piece is firmly held or clamped to prevent movement.

The blade guard must be held firmly against the material being cut to reduce saw vibration, blade jumping and blade breakage.

MAINTENANCE

Remove the plug from the socket before carrying out any adjustment, servicing or maintenance.

There are no user serviceable parts in your power tool. Never use water or chemical cleaners to clean your power tool. Wipe clean with a dry cloth. Always store your power tool in a dry place. Keep the motor

ventilation slots clean. Keep all working controls free of dust. Occasionally you may see sparks through the ventilation slots. This is normal and will not damage your power tool.

If the supply cord is damaged, it must be replaced by the manufacturer, its service agent or similarly qualified persons in order to avoid a hazard.

WORX
you've got the power